

SYNCOPE® 2000FA 00

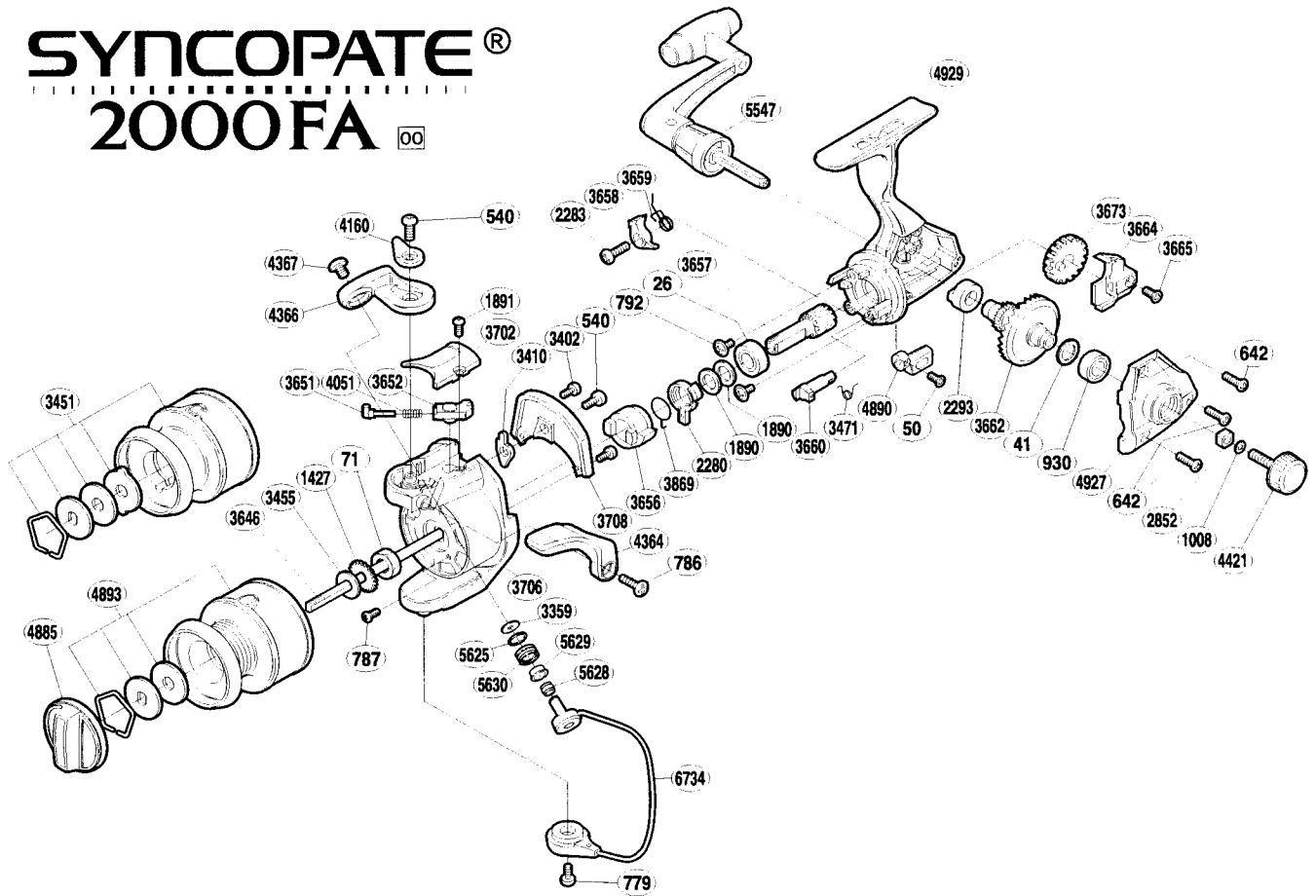

| Part No. | Description |
|----------|--------------------------|
| RD 0026 | Ball Bearing |
| RD 0041 | Drive Gear Washer |
| RD 0050 | Anti-Reverse Lever Screw |
| RD 0071 | Rotor Nut |
| RD 0540 | Multi-Purpose Screw |
| RD 0642 | Side Cover Screw |
| RD 0779 | Bail Hold Support Screw |
| RD 0786 | Trigger Screw |
| RD 0787 | Nut Lock Screw |
| RD 0792 | Bearing Retainer Screw |
| RD 0930 | Ball Bearing |
| RD 1008 | Handle Lock Washer |
| RD 1427 | Spool Support |
| RD 1890 | Bushing Washer |
| RD 1891 | Bail Spring Cover Screw |
| RD 2280 | Anti-Reverse Lock Out |
| RD 2283 | Anti-Reverse Pawl Screw |
| RD 2293 | Drive Gear Bushing |
| RD 2852 | Handle Screw Lock |
| RD 3359 | Line Roller Washer |

| Part No. | Description |
|----------|---------------------------|
| RD 3402 | Cover Screw |
| RD 3410 | Bail Trip Lever |
| RD 3451 | Spool Assembly (graphite) |
| RD 3455 | Spool Washer |
| RD 3471 | Anti-Reverse Cam Spring |
| RD 3646 | Main Shaft |
| RD 3651 | Bail Spring Guide (A) |
| RD 3652 | Bail Spring Guide (B) |
| RD 3656 | Anti-Reverse Ratchet |
| RD 3657 | Pinion Gear |
| RD 3658 | Anti-Reverse Pawl |
| RD 3659 | Anti-Reverse Pawl Spring |
| RD 3660 | Anti-Reverse Cam |
| RD 3662 | Drive Gear |
| RD 3664 | Oscillating Slider |
| RD 3665 | Slider Retainer Screw |
| RD 3673 | Oscillating Gear |
| RD 3702 | Bail Spring Cover |
| RD 3706 | Rotor |
| RD 3708 | Counterbalance Cover |

| Part No. | Description |
|----------|------------------------------|
| RD 3869 | Anti-Reverse Lock Out Spring |
| RD 4051 | Bail Spring |
| RD 4160 | Trigger Cam |
| RD 4364 | Quick-Fire II Trigger |
| RD 4366 | Bail Arm |
| RD 4367 | Line Roller Screw |
| RD 4421 | Handle Screw Cap |
| RD 4885 | Drag Knob |
| RD 4890 | Anti-Reverse Lever |
| RD 4893 | Spool Assembly (aluminum) |
| RD 4927 | Side Cover |
| RD 4929 | Body |
| RD 5547 | Handle Assembly |
| RD 5625 | Line Roller Spacer |
| RD 5628 | Line Roller Collar |
| RD 5629 | Line Roller Bushing |
| RD 5630 | Line Roller |
| RD 6734 | Bail Assembly |