

SHIMAN

1997 Repair Supplement

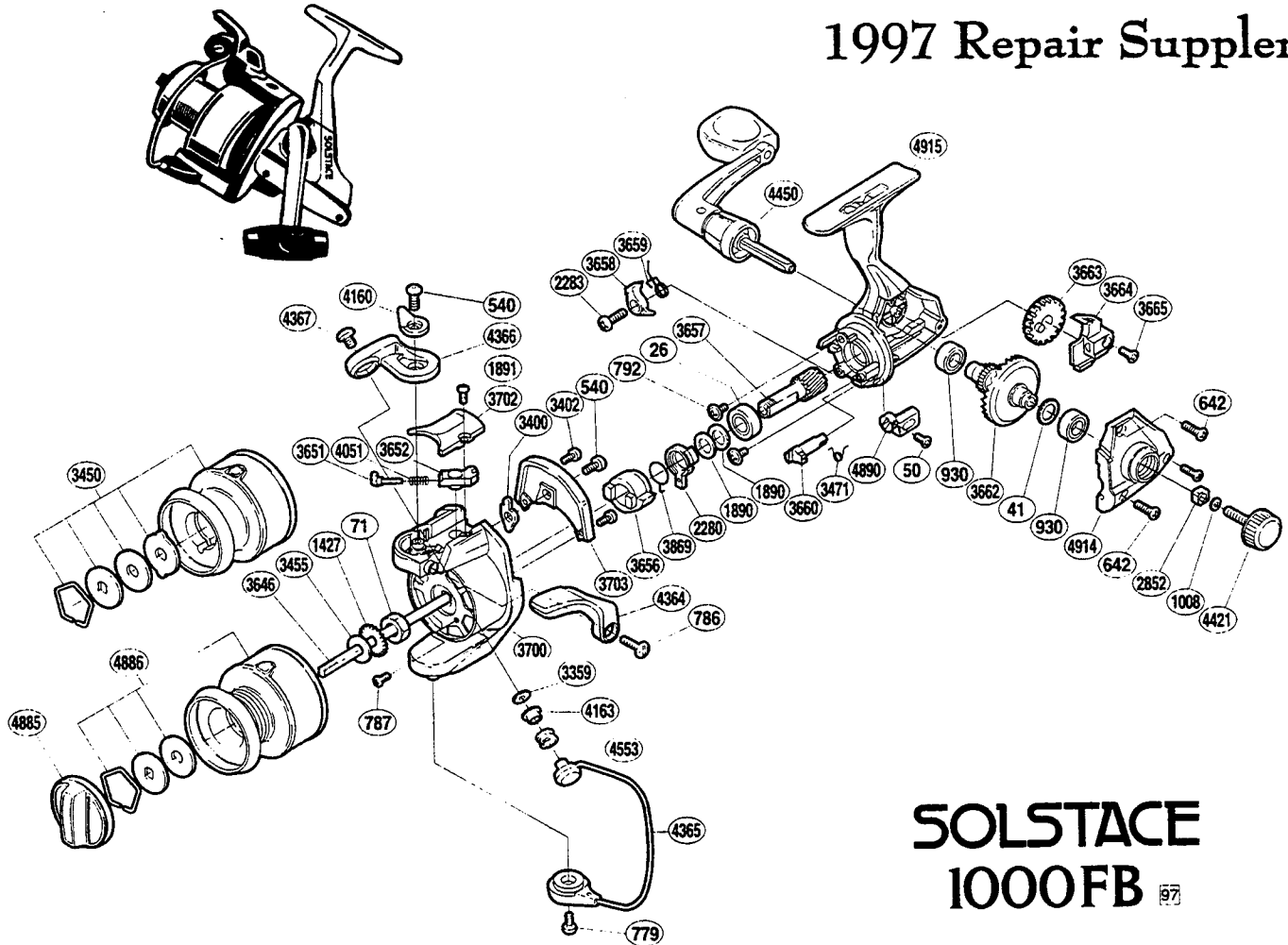

SOLSTACE 1000FB 97

SO-1000FB

| Part # | Description | Part # | Description | Part # | Description |
|---------|--------------------------|---------|---------------------------|---------|--------------------------|
| RD 0026 | Ball Bearing | RD 3400 | Bail Trip Lever | RD 3703 | Counterbalance Cover |
| RD 0041 | Drive Gear Washer | RD 3402 | Cover Screw | RD 3869 | Anti-Reverse Lock |
| RD 0050 | Anti-Reverse Lever Screw | RD 3450 | Spool Assembly (Graphite) | RD 4051 | Bail Spring |
| RD 0071 | Rotor Nut | RD 3455 | Spool Washer | RD 4160 | Trigger Cam |
| RD 0540 | Multi-Purpose Screw | RD 3471 | Anti-Reverse Cam Spring | RD 4163 | Line Roller Bushing |
| RD 0642 | Side Cover Screw | RD 3646 | Main Shaft | RD 4364 | Quick-Fire II Trigger |
| RD 0779 | Bail Hold Support Screw | RD 3651 | Bail Spring Guide (A) | RD 4365 | Bail Assembly |
| RD 0786 | Trigger Screw | RD 3652 | Bail Spring Guide (B) | RD 4366 | Bail Arm |
| RD 0787 | Nut Lock Screw | RD 3656 | Anti-Reverse Ratchet | RD 4367 | Line Roller Screw |
| RD 0792 | Bearing Retainer Screw | RD 3657 | Pinion Gear | RD 4421 | Handle Screw Cap |
| RD 0930 | Ball Bearing | RD 3658 | Anti-Reverse Pawl | RD 4450 | Handle Assembly |
| RD 1008 | Handle Lock Washer | RD 3659 | Anti-Reverse Pawl Spring | RD 4553 | Line Roller |
| RD 1427 | Spool Support | RD 3660 | Anti-Reverse Cam | RD 4885 | Drag Knob |
| RD 1890 | Bushing Washer | RD 3662 | Drive Gear | RD 4886 | Spool Assembly (Alumin.) |
| RD 1891 | Bail Spring Cover Screw | RD 3663 | Oscillating Gear | RD 4890 | Anti-Reverse Lever |
| RD 2280 | Anti-Reverse Lockout | RD 3664 | Oscillating Slider | RD 4914 | Side Cover |
| RD 2283 | Anti-Reverse Pawl Screw | RD 3665 | Slider Retainer Screw | RD 4915 | Body |
| RD 2852 | Handle Screw Lock | RD 3700 | Rotor | | |
| RD 3359 | Line Roller Washer | RD 3702 | Bail Spring Cover | | |