

SHIMAN

1997 Repair Supplier

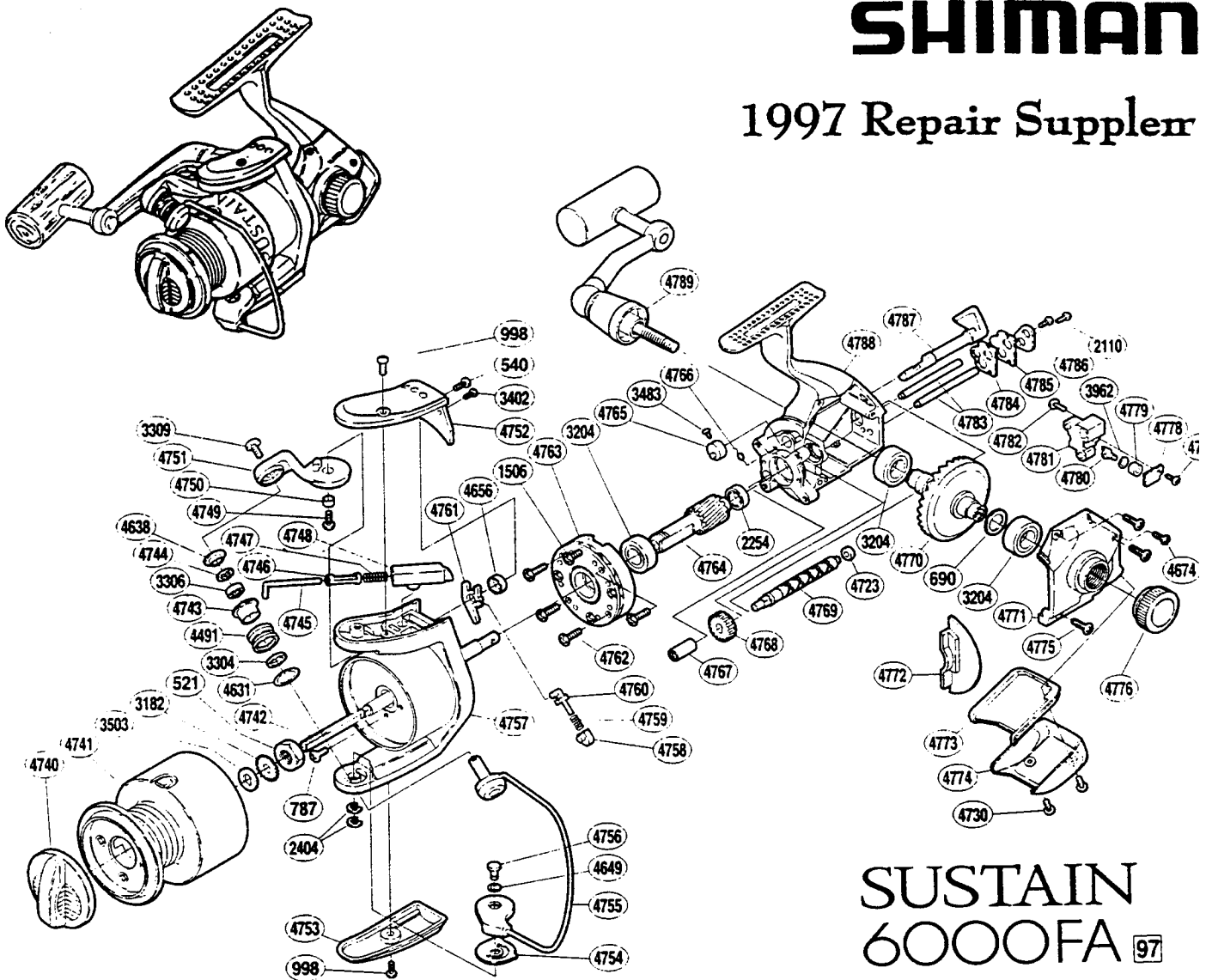

SUSTAIN 6000FA 97

SA6000FA

Part #	Description	Part #	Description	Part #	Description
RD 0521	Rotor Nut	RD 4740	Drag Knob	RD 4766	Anti-Reverse Cam Spring
RD 0540	Bail Spring Cover Screw (LG)	RD 4741	Spool Assembly	RD 4767	Worm Bushing (Front)
RD 0690	Drive Gear Washer	RD 4742	Main Shaft	RD 4768	Idle Gear
RD 0787	Nut Lock Screw	RD 4743	Line Roller Bushing	RD 4769	Worm Shaft
RD 0898	Cover Screw (Long)	RD 4744	Roller Bearing Seal	RD 4770	Drive Gear
RD 1506	Clutch Cover Screw	RD 4745	Bail Spring Guide (A)	RD 4771	Side Cover
RD 2110	Worm Shaft Retainer Screw	RD 4746	Spring Guide (A) Support	RD 4772	Side Cover Flange
RD 2254	Ball Bearing	RD 4747	Bail Spring	RD 4773	Rear Shield
RD 2404	"E" Lock	RD 4748	Bail Spring Guide (B)	RD 4774	Rear Protector
RD 3128	Spool Support	RD 4749	Bail Arm Screw	RD 4775	Side Cover Screw (LG)
RD 3204	Ball Bearing	RD 4750	Bail Arm Bushing	RD 4776	Handle Screw Cap
RD 3304	Bearing Spacer	RD 4751	Bail Arm	RD 4777	Oscillating Pawl Cover Screw
RD 3306	Line Roller Bearing	RD 4752	Bail Spring Cover	RD 4778	Oscillating Pawl Cover
RD 3309	Line Roller Screw	RD 4753	Bail Hold Support Guard	RD 4779	Oscillating Slider Bushing
RD 3402	Bail Spring Cover Screw (Sm)	RD 4754	Bail Hold Support Spacer	RD 4780	Oscillating Pawl
RD 3483	Anti-Reverse Cam Screw	RD 4756	Bail Hold Support Shaft	RD 4781	Oscillating Slider
RD 3503	Spool Washer	RD 4757	Rotor	RD 4782	Slider Retainer Screw
RD 3962	Spacer	RD 4758	Lever Spring Guide (B)	RD 4783	Oscillating Guide
RD 4491	Line Roller	RD 4759	Lever Spring	RD 4784	Worm Shaft Retainer Washer
RD 4631	Spacer	RD 4760	Lever Spring Guide (A)	RD 4785	Worm Shaft Retainer
RD 4638	Line Roller Washer	RD 4761	Bail Trip Lever	RD 4786	Worm Shaft Retainer Spacer
RD 4656	Trip Lever Spacer	RD 4762	Roller Clutch Screw	RD 4787	Anti-Reverse Lever
RD 4674	Side Cover Screw (Small)	RD 4763	Roller Clutch Assembly	RD 4788	Body
RD 4723	Worm Bushing (Rear)	RD 4764	Pinion Gear	RD 4789	Handle Assembly
RD 4730	Rear Protector Screw	RD 4765	Anti-Reverse Cam	RD 5353	Bail Assembly