

Exploded View

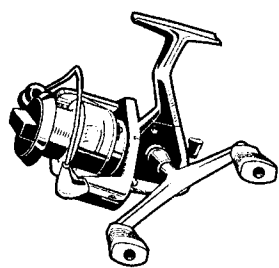

DYNA-BALANCE

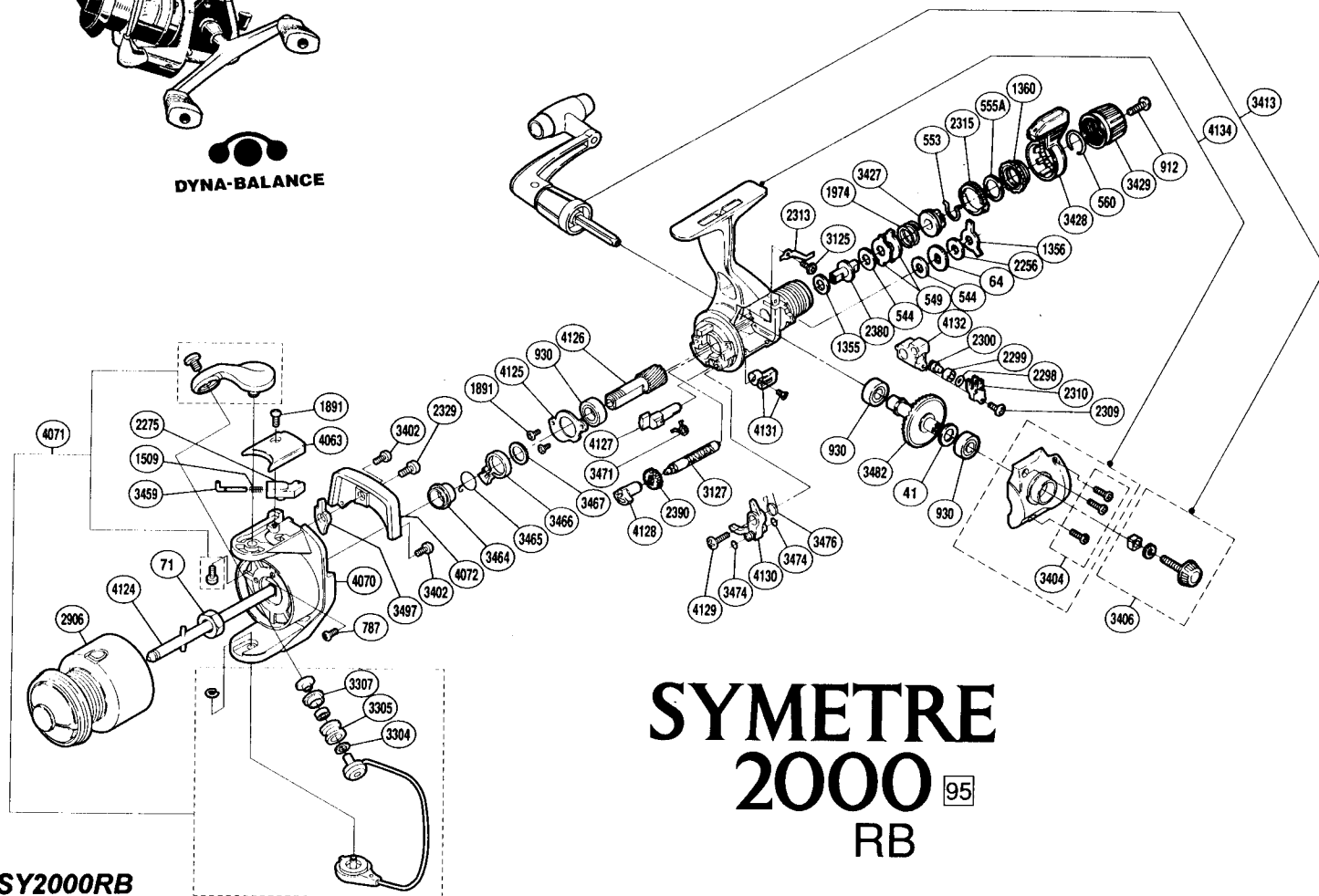

SYMETRE 2000⁹⁵ RB

SY2000RB

Part #	Description	Part #	Description	Part #	Description
RD 0041	Drive Gear Washer	RD 2309	Slider Retainer Screw	RD 3465	Anti-Reverse Lock Out Spring
RD 0064	Click Gear	RD 2310	Oscillating Slider Retainer	RD 3466	Anti-Reverse Lock Out
RD 0071	Rotor Nut	RD 2313	Drag Click	RD 3467	Bushing Washer
RD 0544	Drag Washer "C" (cloth)	RD 2315	Lever Click Gear	RD 3471	Anti-Reverse Cam Spring
RD 0549	Eared Washer "B"	RD 2329	Bail Trip Lever Screw	RD 3474	"O" Ring
RD 0553	Hold Click Spring	RD 2380	Drag Shaft	RD 3476	Anti-Reverse Pawl Spring
RD 0555A	Fightin' Pressure Screw Washer	RD 2390	Idle Gear	RD 3482	Drive Gear
RD 0560	Lever Hold Spring	RD 2906	Spool Assembly	RD 3497	Bail Trip Lever
RD 0787	Nut Lock Screw	RD 3125	Drag Click Screw	RD 4063	Bail Spring Cover
RD 0912	Drag Programmer Screw	RD 3127	Worm Shaft	RD 4070	Rotor
RD 0930	Ball Bearing	RD 3304	Bearing Spacer	RD 4071	Bail Assembly
RD 1355	Drag Washer "C" (white)	RD 3305	SIC Ceramic Roller	RD 4072	Counterbalance Cover
RD 1356	Eared Washer "B"	RD 3307	Line Roller Bushing	RD 4124	Main Shaft
RD 1360	Fightin' Pressure Screw	RD 3402	Cover Screw	RD 4125	Bearing Retainer
RD 1509	Bail Spring	RD 3404	Side Cover Screws	RD 4126	Pinion Gear
RD 1891	Multi Purpose Screw	RD 3406	Handle Screw Cap Assembly	RD 4127	Anti-Reverse Cam
RD 1974	Drag Coil Spring	RD 3413	Handle Assembly	RD 4128	Worm Bushing
RD 2256	Drag Washer "C" (blue)	RD 3427	Pressure Screw Assembly	RD 4129	Anti-Reverse Pawl Screw
RD 2275	Bail Spring Guide (B)	RD 3428	Fightin' Drag II Lever	RD 4130	Anti-Reverse Pawl
RD 2298	Spacer	RD 3429	Drag Programmer	RD 4131	Anti-Reverse Lever Assembly
RD 2299	Oscillating Slide Bushing	RD 3459	Bail Spring Guide (A)	RD 4132	Oscillating Slider
RD 2300	Oscillating Pawl	RD 3464	Lock Out Spring Holder	RD 4134	Body Assembly