

Exploded View

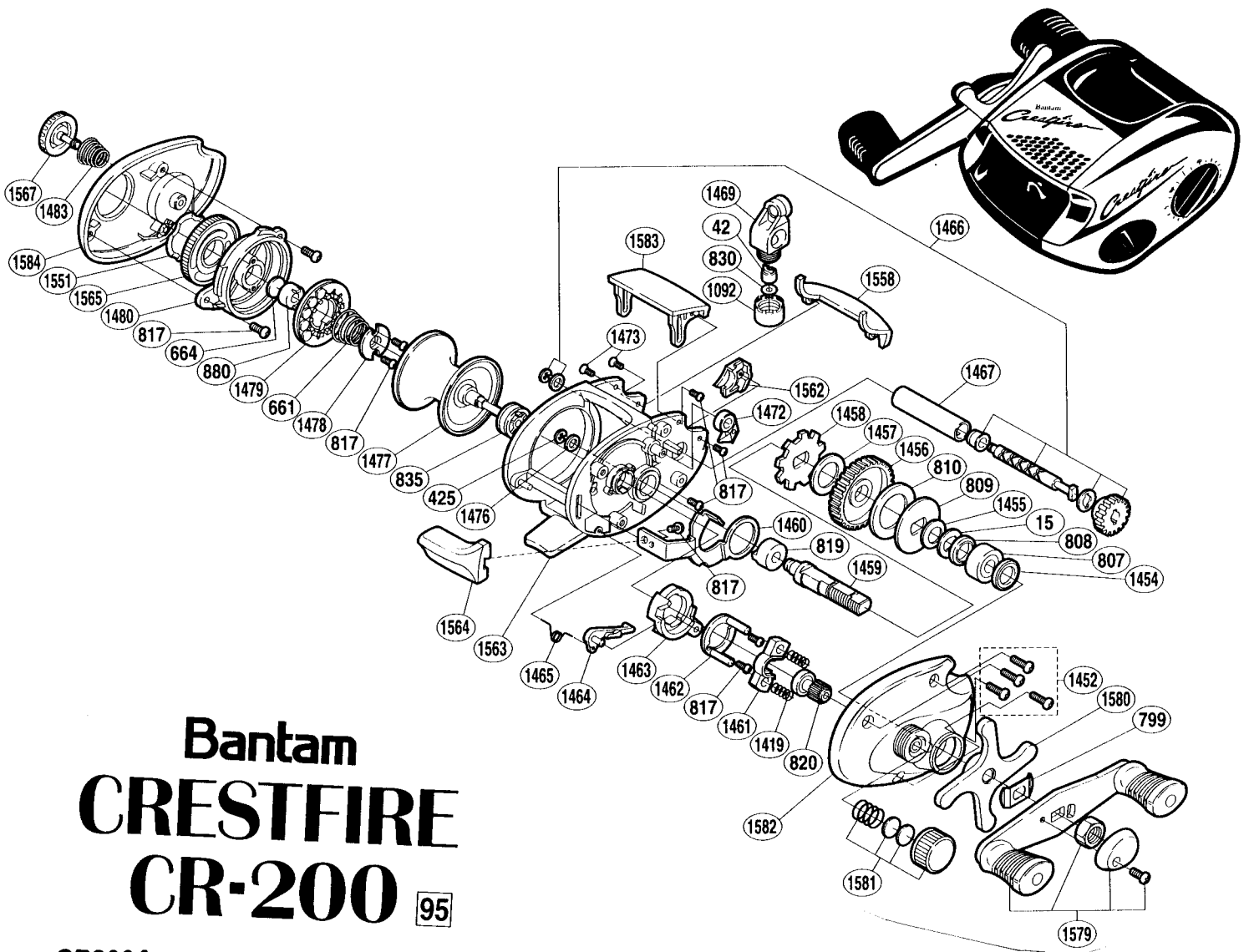

Bantam CRESTFIRE CR-200 95

CR200A

Part #	Description	Part #	Description	Part #	Description
BNT0015	Drag Spring Washer	BNT1454	Bearing Bushing	BNT1478	Magnet Holder
BNT0042	Line Guide Pawl	BNT1455	Drag Spring Washer	BNT1479	Magnet Retainer
BNT0425	Drive Gear Retainer	BNT1456	Drive Gear	BNT1480	Dial Case
BNT0661	Magnet Retainer Spring	BNT1457	Drive Shaft Washer (B)	BNT1483	Lock Spring
BNT0664	Spacer (B)	BNT1458	Anti-Reverse Ratchet	BNT1551	Dial Friction Washer
BNT0799	Friction Washer	BNT1459	Drive Shaft	BNT1558	Level Wind Protector
BNT0807	Drive Shaft Bearing	BNT1460	Clutch Plate	BNT1562	Drive Shaft Cover
BNT0808	Friction Washer (B)	BNT1460	Yoke	BNT1563	One-Piece Frame
BNT0809	Key Washer	BNT1462	Clutch Cam Retainer	BNT1564	Quick-Fire II Clutch Bar
BNT0810	Drag Washer	BNT1463	Clutch Cam	BNT1565	Magnet Control Dial
BNT0817	Multi Purpose Screw	BNT1464	Clutch Pawl	BNT1567	Lock Screw Cap
BNT0819	Drive Shaft Bushing	BNT1465	Clutch Pawl Spring	BNT1579	Handle Assembly
BNT0820	Pinion Gear	BNT1466	Worm Shaft Assembly	BNT1580	Star Drag
BNT0830	Spacer (optional)	BNT1467	Level Wind Guard	BNT1581	Cast Control Cap Assembly
BNT0835	Spool Shaft Bushing (B)	BNT1469	Line Guide	BNT1582	Right Side Plate
BNT0880	Spool Shaft Bushing (C)	BNT1472	Anti-Reverse Pawl	BNT1583	Thumb Rest
BNT1092	Pawl Cap	BNT1473	Multi Purpose Screw	BNT1584	Left Side Plate
BNT1419	Yoke Spring	BNT1476	Drive Shaft Washer (D)		
BNT1452	Side Plate Screws	BNT1477	Spool		